



# Modular Cooking Range Line 700XP One Well Freestanding Gas Fryer 7 liter

ITEM # \_\_\_\_\_

MODEL # \_\_\_\_\_

NAME # \_\_\_\_\_

SIS # \_\_\_\_\_

AIA # \_\_\_\_\_



371068 (E7FRGD1BF0)

7-lt gas Fryer free standing with 1 "V" shape well (external Burners) and 1 basket

## Short Form Specification

Item No. \_\_\_\_\_

To be installed on height adjustable feet in stainless steel. High efficiency 7 kW burners in stainless steel. Suitable for natural gas or LPG. Deep drawn V-shaped well. Oil drains through a tap into a container under the well. Exterior panels in stainless steel with Scotch Brite finish. One piece pressed work top in 1.5 mm thick stainless steel. Right-angled side edges to allow flush-fitting junction between units.

## Main Features

- Unit to be mounted on 50mm height adjustable feet in stainless steel.
- Deep drawn V-Shaped well.
- High efficiency 7 kW burners in stainless steel with flame failure device attached to the outside of the well.
- Thermostatic regulation of oil temperature up to a maximum of 185 °C.
- Flame failure device on each burner.
- Overheat protection thermostat as standard on all units.
- Oil drains through a tap into a drainage container positioned under the well.
- All major compartments located in front of unit for ease of maintenance.
- Piezo spark ignition for added safety.
- Gas appliance supplied for use with natural or LPG gas, conversion jets supplied as standard.
- IPx4 water protection.
- Optional portable oil quality monitoring tool (code 9B8081) for efficient oil management.

## Construction

- Interior of well with rounded corners for ease of cleaning.
- All exterior panels in Stainless Steel with Scotch Brite finishing.
- One piece pressed 1.5 mm work top in Stainless steel.
- Model has right-angled side edges to allow flush fitting joints between units, eliminating gaps and possible dirt traps.

## Sustainability



- This model is compliant with Swiss Energy Efficiency Ordinance (730.02).

## Included Accessories

- 1 of Door for open base PNC 206350 cupboard
- 1 of Basket for 7lt top and free PNC 921608 standing fryers

## Optional Accessories

- Junction sealing kit PNC 206086
- Draught diverter, 120 mm diameter PNC 206126
- Matching ring for flue condenser, 120 mm diameter PNC 206127
- Flanged feet kit PNC 206136
- Frontal kicking strip for concrete installation, 400mm PNC 206147

APPROVAL: \_\_\_\_\_



Experience the Excellence  
www.electroluxprofessional.com

- |  |            |                          |   |            |                          |
|--|------------|--------------------------|---|------------|--------------------------|
| • Frontal kicking strip for concrete installation, 800mm                         | PNC 206148 | <input type="checkbox"/> | • Pressure regulator for gas units            | PNC 927225 | <input type="checkbox"/> |
| • Frontal kicking strip for concrete installation, 1000mm                        | PNC 206150 | <input type="checkbox"/> | • 2 baskets for 2x5lt and 7lt electric fryers | PNC 960638 | <input type="checkbox"/> |
| • Frontal kicking strip for concrete installation, 1200mm                        | PNC 206151 | <input type="checkbox"/> |   |            |                          |
| • Frontal kicking strip for concrete installation, 1600mm                        | PNC 206152 | <input type="checkbox"/> |   |            |                          |
| • Frontal kicking strip, 400mm (not for refr-freezer base)                       | PNC 206175 | <input type="checkbox"/> |   |            |                          |
| • Frontal kicking strip, 800mm (not for refr-freezer base)                       | PNC 206176 | <input type="checkbox"/> |   |            |                          |
| • Frontal kicking strip, 1000mm (not for refr-freezer base)                      | PNC 206177 | <input type="checkbox"/> |   |            |                          |
| • Frontal kicking strip, 1200mm (not for refr-freezer base)                      | PNC 206178 | <input type="checkbox"/> |   |            |                          |
| • Frontal kicking strip, 1600mm (not for refr-freezer base)                      | PNC 206179 | <input type="checkbox"/> |   |            |                          |
| • Kit 4 feet for concrete installation (not for 900 line free standing grill)    | PNC 206210 | <input type="checkbox"/> |   |            |                          |
| • Pair of side kicking strips  | PNC 206249 | <input type="checkbox"/> |   |            |                          |
| • Pair of side kicking strips for concrete installation                          | PNC 206265 | <input type="checkbox"/> |   |            |                          |
| • Chimney upstand, 400mm   | PNC 206303 | <input type="checkbox"/> |   |            |                          |
| • Right and left side handrails  | PNC 206307 | <input type="checkbox"/> |   |            |                          |
| • Back handrail 800 mm   | PNC 206308 | <input type="checkbox"/> |   |            |                          |
| • Flue condenser for 1/2 module, 120 mm diameter                                 | PNC 206310 | <input type="checkbox"/> |   |            |                          |
| • Door for open base cupboard  | PNC 206350 | <input type="checkbox"/> |   |            |                          |
| • Base support for feet or wheels - 400mm (700/900)                              | PNC 206366 | <input type="checkbox"/> |   |            |                          |
| • Base support for feet or wheels - 800mm (700/900)                              | PNC 206367 | <input type="checkbox"/> |   |            |                          |
| • Base support for feet or wheels - 1200mm (700/900)                             | PNC 206368 | <input type="checkbox"/> |   |            |                          |
| • Base support for feet or wheels - 1600mm (700/900)                             | PNC 206369 | <input type="checkbox"/> |   |            |                          |
| • Base support for feet or wheels - 2000mm (700/900)                             | PNC 206370 | <input type="checkbox"/> |   |            |                          |
| • Rear paneling - 600mm (700/900XP)  | PNC 206373 | <input type="checkbox"/> |   |            |                          |
| • Rear paneling - 800mm (700/900)  | PNC 206374 | <input type="checkbox"/> |   |            |                          |
| • Rear paneling - 1000mm (700/900)   | PNC 206375 | <input type="checkbox"/> |   |            |                          |
| • Rear paneling - 1200mm (700/900)   | PNC 206376 | <input type="checkbox"/> |   |            |                          |
| • Kit town gas nozzles (G150) for 700 grill                                      | PNC 206389 | <input type="checkbox"/> |   |            |                          |
| • Chimney grid net, 400mm (700XP/900)  | PNC 206400 | <input type="checkbox"/> |   |            |                          |
| • Base support for feet or wheels - 600mm (700/900)                              | PNC 206431 | <input type="checkbox"/> |   |            |                          |
| • Kit G.25.3 (NI) gas nozzles for 900 fryers                                     | PNC 206467 | <input type="checkbox"/> |   |            |                          |
| • 2 side covering panels for free standing appliances                            | PNC 216000 | <input type="checkbox"/> |   |            |                          |
| • Basket for 7lt top and free standing fryers                                    | PNC 921608 | <input type="checkbox"/> |   |            |                          |
| • Filter for fryer oil collection basin for 7lt, 14lt, 15lt free standing fryers | PNC 921693 | <input type="checkbox"/> |   |            |                          |

Front

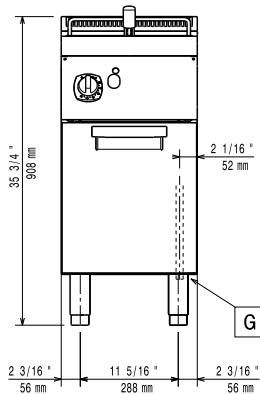

Side

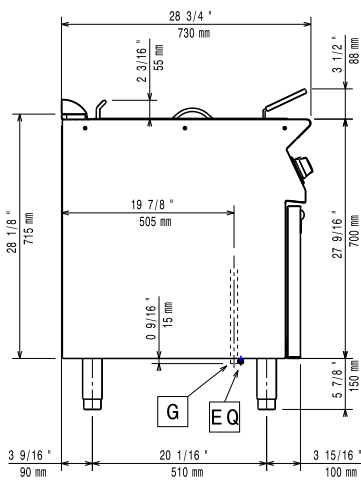

EQ = Equipotential screw  
 G = Gas connection

Top

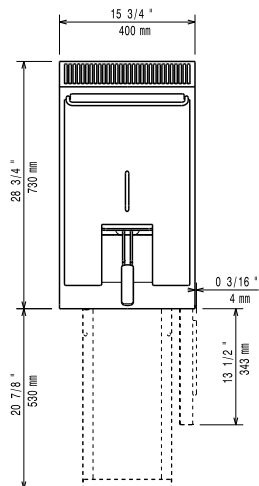

### Gas

|                               |                          |
|-------------------------------|--------------------------|
| <b>Gas Power:</b>             | 7 kW                     |
| <b>371068 (E7FRGD1BF0)</b>    |                          |
| <b>Standard gas delivery:</b> | Natural Gas G20 (20mbar) |
| <b>Gas Type Option:</b>       | LPG; Natural Gas         |
| <b>Gas Inlet:</b>             | 1/2"                     |
| <b>LPG Gas Pressure:</b>      | 11" w.c. (27.7 mbar)     |

### Key Information:

|   |                        |
|---|------------------------|
| <b>Usable well dimensions (width):</b>  | 240 mm                 |
| <b>Usable well dimensions (height):</b> | 235 mm                 |
| <b>Usable well dimensions (depth):</b>  | 380 mm                 |
| <b>Well capacity:</b>                   | 5.5 lt MIN; 7 lt MAX   |
| <b>Thermostat Range:</b>                | 105 °C MIN; 185 °C MAX |
| <b>Net weight:</b>                      | 40 kg                  |
| <b>Shipping weight:</b>                 | 48 kg                  |
| <b>Shipping height:</b>                 | 1120 mm                |
| <b>Shipping width:</b>                  | 460 mm                 |
| <b>Shipping depth:</b>                  | 820 mm                 |
| <b>Shipping volume:</b>                 | 0.42 m <sup>3</sup>    |

If appliance is set up or next to or against temperature sensitive furniture or similar, a safety gap of approximately 150 mm should be maintained or some form of heat insulation fitted.

**Certification group:** N7FG